

ECONOMIC PROFILE

Village of Union Grove, WI

POPULATION

<u>Year</u>	<u>Number</u>	<u>Percent Change</u>
1980	3,517	--
1990	3,669	4.3
2000	4,322	17.8
2004 (est.)	4,459	3.2

Source: U.S. Bureau of the Census, Wisconsin Department of Administration and SEWRPC.

HOUSING

<u>Year</u>	<u>Total Households</u>	<u>Percent Change</u>
1980	1,159	--
1990	1,289	11.2
2000	1,631	26.5

Unit Information: 2000

Total Units.....	1,677
Owner Occupied.....	1,004
Median Value.....	\$124,700
Renter Occupied.....	627
Median Rent.....	\$548
Vacancy Rate.....	4.7%

Units Authorized by Building Permits: 2003

Total Units.....	24
------------------	----

Source: U.S. Bureau of the Census and SEWRPC.

INCOME

2002 Per Capital Personal Income

Racine County.....	\$30,331
Southeastern Wisconsin Region.....	34,014
Wisconsin.....	30,050
United States.....	30,906

Source: U.S. Bureau of Economic Analysis and SEWRPC.

TAXES

Local Property Taxes

- Assessment Ratio: 0.850121716 (2004)
- Net Rate/\$1,000: \$24.00 (2004)
- Total Equalized Value: \$256,673,700 (2004)

Source: Wisconsin Department of Revenue and Village of Union Grove.

TRANSPORTATION

Highways

- Interstate Highway 94 is located five miles east
- State Trunk Highway 11 (15th Avenue or Durand Avenue)
- United States Highway 45 (Main Street or S. Colony Avenue)

Public Transit

- Transit service for the elderly and persons with disabilities provided through a program administered by the Racine County Human Services Department

Railway Service

- Canadian Pacific Railway
- METRA service to downtown Chicago, available from downtown Kenosha (14 miles away)

Water Transportation Facilities

- Port of Milwaukee located 28 miles northeast

Trucking

- 86 trucking establishments located in Racine County

Air Service

- John H. Batten Field, located 14 miles northeast
- Sylvania Airport, located 5 miles east
- Milwaukee's General Mitchell International Airport, located 23 miles northeast
- Chicago's O'Hare International Airport, located 60 miles southeast

GOVERNMENT SERVICES

The Village of Union Grove has an elected Village President/Trustee form of government. It also has a Village Administrator.

Police and Fire

Police protection is provided by the Racine County Sheriff's Department. The Union Grove-Yorkville Fire Department has 35 volunteers who are Fire Fighters I and II and Emergency Medical Technicians. The Fire Department participates in mutual aid and hazardous materials operations. The Fire Department Rescue Squad is licensed to provide advanced life support.

Countywide 911 coverage of emergency calls.

Other

The Village provides standard services such as street maintenance, snow removal, residential refuse collection, street lighting, centrally located public library, and a parks and recreation program.

LABOR AND WAGES

RACINE COUNTY AVERAGE EMPLOYMENT: 2004

<u>Employment by Industry</u>	<u>Number of Persons Employed</u>	<u>Percent of Persons Employed</u>
Construction.....	3,915	5.2
Education and Health.....	14,752	19.4
Financial Activities.....	2,448	3.2
Information.....	Suppressed	Suppressed
Leisure and Hospitality.....	6,647	8.8
Manufacturing.....	19,013	25.1
Natural Resources.....	380	0.5
Other Services.....	2,385	3.1
Professional and Business Services.....	6,226	8.2
Public Administration.....	4,178	5.5
Trade, Transportation, and Utilities.....	15,259	20.2
Not Assigned.....	Suppressed	Suppressed
Total.....	75,879*	100.0*

*The total does not equal the sum of the individual categories due to data suppression.

Note: Table revised July 2005.

Source: Wisconsin Department of Workforce Development, Office of Economic Advisors (Quarterly Census of Employment and Wages) and SEWRPC.

MEDIAN HOURLY WAGES FOR SELECTED OCCUPATIONS: 2003

Wage and employment estimates categorized by occupation can be found by following the link for the OEA Wage Survey located below.

Racine County OEA Wage Survey
http://www.sewrpc.org/economicprofiles/racine_co

SOUTHEAST WISCONSIN PROJECTED EMPLOYMENT: 2002 – 2012*

Employment projections categorized by occupational groups can be found by following the link of the employment projection report located below.

Southeast Wisconsin
 OEA Employment Projection Report
http://www.sewrpc.org/economicprofiles/racine_co

**Southeast Wisconsin* Includes: Kenosha, Racine, and Walworth Counties.

RACINE COUNTY CIVILIAN LABOR FORCE: MARCH: 2004

Total Civilian Labor Force.....	94,106
Employed Civilian Labor Force.....	86,587
Unemployed Civilian Labor Force.....	7,519

HEALTH

All Saints Healthcare – Union Grove has a staff of three physicians and one nurse practitioner. Another physician, who is associated with Aurora Health Care, three dentists, and a chiropractor all practice in Union Grove. St. Mary's Medical Center and St. Luke's Hospital, Racine, and Memorial Hospital, Burlington, are within a 15- mile radius. All three are served by the Flight For Life helicopter for airborne emergency transportation of critically ill or injured patients. Sports Physical Therapy and Rehab provides rehabilitate services for workers compensation and other cases. Lakeview Rehabilitation Center, Town of Dover, is a residential community re-entry program for individuals with head injuries.

Shepherds Ministries and SERVE enterprises is a nationally known Baptist facility for the developmentally disabled. Eight separate day care centers offer day care services, nursery school, and before and after-school childcare.

Senior citizen apartments are located at Hillpark Heights and Hometown Village. Oak Ridge Care Center is a skilled nursing facility and the adjoining Timber Oaks Group Home offers assisted living.

INDUSTRIAL SITES

Industrial Parks (December 2004)

<u>Name</u>	<u>Total Acres</u>	<u>Available Acres</u>
Union Grove Industrial Park Annex	60	23

Contact: Village Administrator
 Village of Union Grove
 Telephone: (262) 878-1818

Source: Village of Union Grove and SEWRPC.

FINANCIAL

Community State Bank (262) 878-3763
First Banking Center (262) 878-0951
North Shore Bank (262) 878-3737

MAJOR PRIVATE SECTOR AREA EMPLOYERS

MANUFACTURING

Machinery, Except Electrical

Accu-Turn, Inc
Grove Gear/ a division of
Regal-Beloit Corporation
Systematics of S.E. Wisconsin

Primary Metals

American Metalcraft Industries
Grove Die Casting, Inc.
M & W Shops and Kraft-Weld
Metal Fabricators

Distribution

Dean Foods
Frito Lay Distribution
Center

Stone, Clay, and Glass

Products

Grove Concrete & Supply, Inc.

Recycling

Mercury Waste Solutions
Stericycle, Inc.

Rubber and Miscellaneous

Plastic Products

American Roller Company
Plastic Parts, Inc.

SERVICES

Amusement and Recreation

Apple Holler Dinner Theater
Bong State Recreation Area
Great Lakes Dragaway
Ives Grove Golf Links
Old Settler's Bowling, Golf and
Entertainment Center
Racine County Fairgrounds
Racine County Visitors Center
Southeast Wisconsin Sports
Park

Health

All Saints Healthcare – U.G.
Aurora Health Care – U.G.
Oak Ridge Care Center and
Timber Oaks Group Home
Shepherds Ministries and
SERVE Enterprises
Sports Physical Therapy
and Rehab Center

OTHER

Racine County

Farm Service Agency
Soil Conservation Office

State of Wisconsin

Ellsworth Correctional Center
Southern Oaks Girls School
Southern Wisconsin Center
for the Developmentally
Disabled
Southern Wisconsin Veterans
Memorial Cemetery
Vets Clinic
Vets Place Southern Center
Wisconsin Veterans Home

Source: *Classified Directory of Wisconsin Manufacturers, Wisconsin Business Service Directory, Greater Union Grove Area Chamber of Commerce, and SEWRPC.*

EDUCATION

The Village of Union Grove is served by the Union Grove UHS School District.

Public High School Graduates: 2003

Total Graduates.....	128
Average Graduation Rate.....	96.2%

Standardized Test Results: 2004

Based upon the mean scores reported in the nation, Wisconsin students scored the highest in the nation on the American College Test (ACT).

2003 Average ACT Scores

Union Grove UHS School District.....	21.6
Racine County.....	21.8
Wisconsin.....	22.1
United States.....	20.8

Source: *Wisconsin Department of Public Instruction and SEWRPC.*

Libraries: Graham Public Library, part of the Lakeshores Library System

The following post-secondary educational facilities are located within, or in close proximity to, Racine County:

Colleges and Universities

Alverno College, Milwaukee
Cardinal Stritch College, Glendale
Carroll College, Waukesha
Carthage College, Kenosha
Columbia College of Nursing, Milwaukee
Concordia University, Mequon
Marquette University, Milwaukee
Medical College of Wisconsin, Wauwatosa
Milwaukee Institute of Art and Design, Milwaukee
Milwaukee School of Engineering, Milwaukee
Mount Mary College, Milwaukee
University of Wisconsin-Milwaukee, Milwaukee
University of Wisconsin-Parkside, Kenosha County
Wisconsin Lutheran College, Wauwatosa

Technical and Vocational Schools

Gateway Technical College

MEDIA

Local Newspapers

- The Westine Report, Weekly
- The Racine Journal-Times, Daily
- Racine County section of Sunday's Milwaukee Journal-Sentinel

UTILITIES

Electric Power

- We Energies
Service Information: 1-800-242-9137

Telephone

- SBC, Inc.
Business Service Information:
In State: 1-800-660-3000
Out of State: 1-800-447-7738

Natural Gas

- We Energies
Service Information: 1-800-242-9137
Gas Emergency: 1-800-236-9874

Solid Waste

- The Village of Union Grove provides refuse collection for residential users. Apartments and large industrial users contract with private collectors for services.
- Mandatory recycling is required for all residential properties and is provided by the village.

Water

- Union Grove Water Utility District
Water and Wastewater Utility Office
Pumping Capacity:
3.7 million gallons/day
Average Daily Consumption:
0.83 million gallons/day
Rate Information: (262) 878-1818

Sanitary Sewerage

- Union Grove Wastewater Treatment Facility
Water and Wastewater Utility Office
Average Annual Hydraulic Loading:
2 million gallons per day
Average Hydraulic Design Capacity:
2 million gallons per day
Rate Information: (262) 878-1818

LOCAL CONTACTS

For industrial, commercial, or business information about the Village of Union Grove, contact:

- Village Administrator
Village of Union Grove
925 15th Avenue
Union Grove, Wisconsin 53182
Telephone: (262) 878-1818
Facsimile: (262) 878-3782
E-Mail: villadmin@plazaeearth.com
Website: www.uniongrove.net
- Greater Union Grove Area
Chamber of Commerce
925 15th Avenue
Union Grove, Wisconsin 53182
Telephone: (262) 878-4606
Facsimile: (262) 878-9125
E-Mail: ugchamber@wi.net
Website: www.uniongrovechamber.org
- Executive Director
Racine County Economic Development Corporation
2320 Renaissance Boulevard
Sturtevant, WI 53177
Telephone: (262) 898-7400
Facsimile: (262) 898-7401
- Community Development Manager
We Energies
231 W. Michigan Street
Milwaukee, WI 53203
Telephone: (414) 221-3018
Facsimile: (414) 221-3853
- Southeastern Wisconsin Regional Planning
Commission
P.O. Box 1607
Waukesha, Wisconsin 53187-1607
Telephone: (262) 547-6721
Facsimile: (262) 547-1103

This profile is one in a series of regional, county, and community profiles prepared by the Southeastern Wisconsin Regional Planning Commission in cooperation with the Regional Economic Partnership as a community service.

Revision date: May 2005



Village of Union Grove

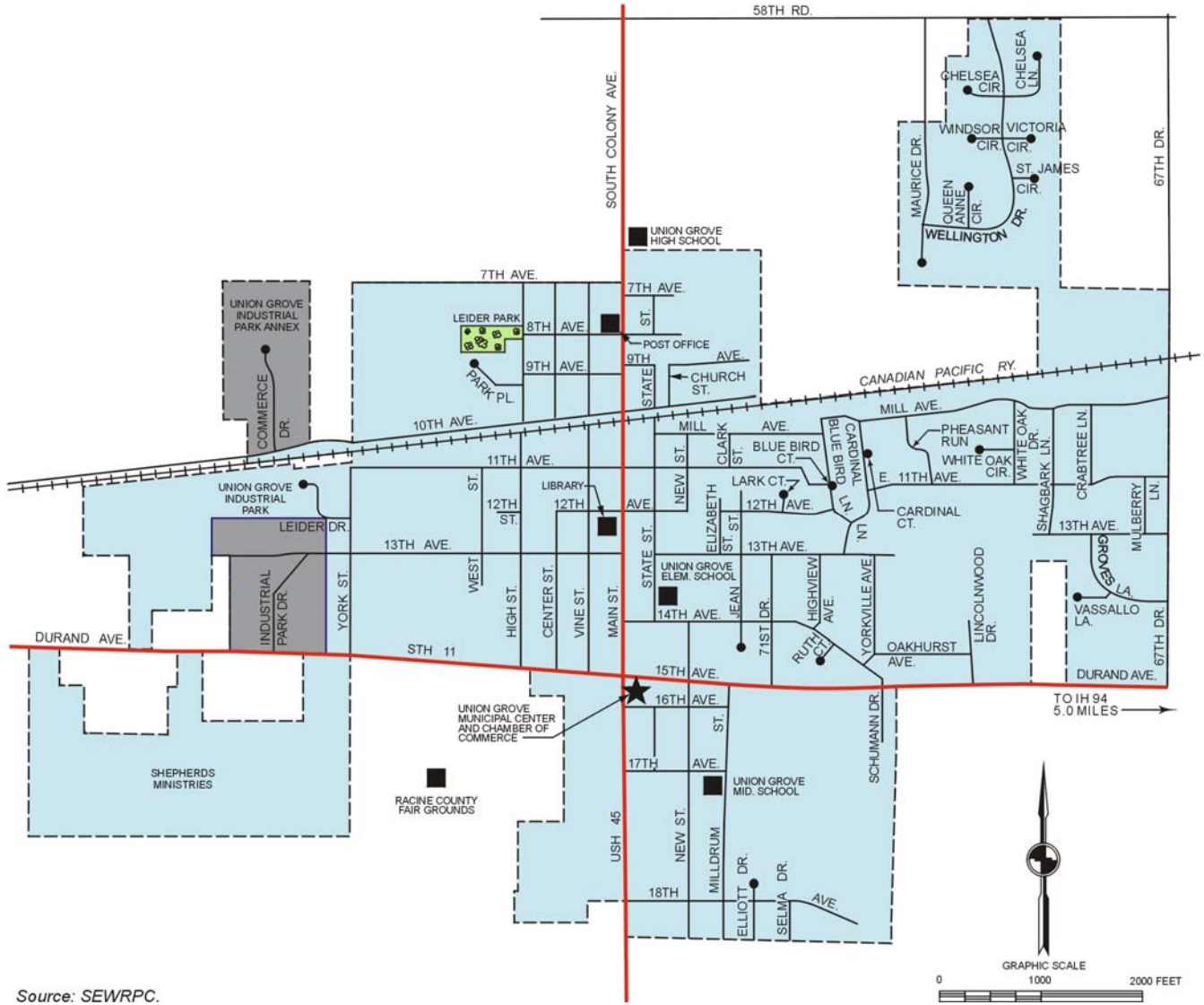

Source: SEWRPC.